



LET'S GO COZY COUPE

COLOR CHANGE CAR WASH™

WARNING:
CHOKING HAZARD—Small parts.
Not for children under 3 years.

AGE 3+

ADULT SUPERVISION REQUIRED

SKU: 661297

CONTENTS

- A. Car Wash
- B. Go Green Truck
- C. Shovel
- D. Rake
- E. Wagon
- F. Cloth

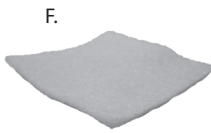
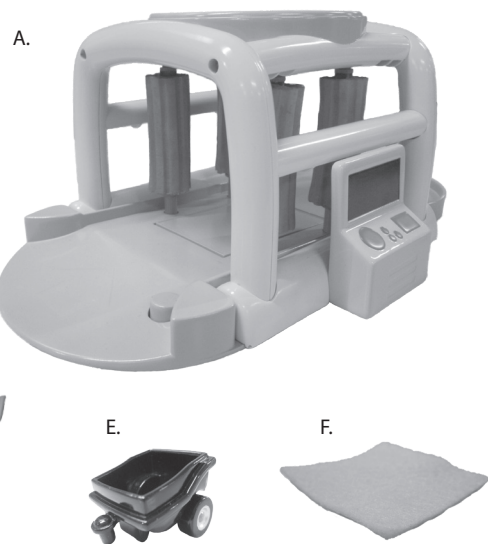

Illustrations are for reference only. Styles may vary from actual contents.

Please remove all packaging including tags, ties & tacking stitches before giving this product to a child.

QUICK START

Before beginning, cover the play area to prevent possible water damage.

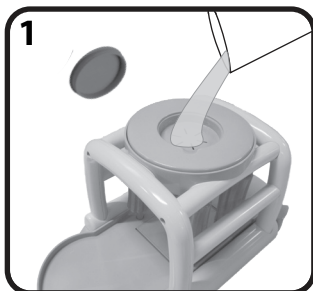

1 Open the top lid to fill with ice cold water. Then watch as it showers your vehicle, causing it to color-change.

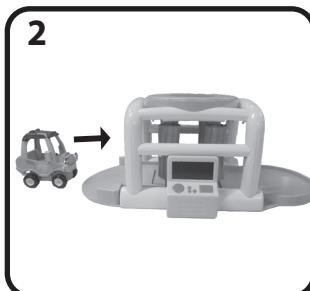

2 Drive any **Cozy Coupe® color-changing vehicles** into the car wash. Let it sit in the middle of the spinners as you wash it.

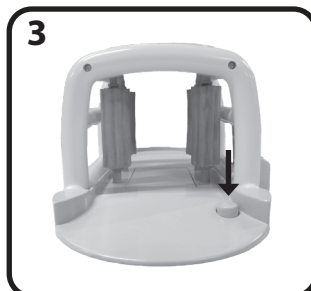

3 Press on the button, as seen above, to roll your vehicles out of the car wash.

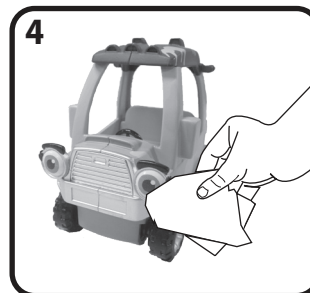

4 Dip a dry cloth into ice cold water. Then, in a circular motion, wipe the spots off of your vehicle to make them disappear.



5 **Another way to play:** Allow the vehicles to cool down or submerge in warm water (do not use hot water) to immediately revert back to their original colors.

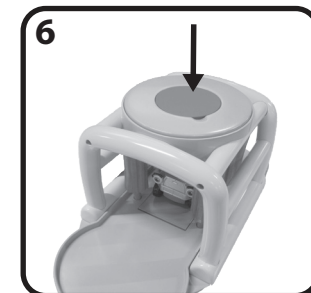

6 Replace the lid when you are finished playing.

WARNING:

- Remember to use warm water, not hot water, to revert vehicles back to their original colors. HOT will shorten/affect the color changing lifespan.
- Adult supervision is required when children are playing around water.
- Do not allow children to play with water near an electrical source or apparatus in order to avoid electric shock and/or electrocution.
- Do not leave items filled with water near electrical devices.

IMPORTANT INFORMATION

- For best results, use ice water at approximately 32°F (0°C) for cold color change.
- Warm color change will start at approximately 100.4°F (38°C), but best results occur if the water is approximately 104°F (40°C).
- If color change does not work properly or quickly, the temperature of the vehicle may be too close to the temperature of the water.
- Color change temperatures may vary according to weather conditions.
- Extreme weather conditions may cause the color change pattern to appear upon arrival. To return it to its original color, place the vehicle in a room temperature area at approximately 68-77°F (20-25°C).
- Do not place vehicle in extremely hot water.
- The color change effect of the vehicle has a lengthy, but limited lifespan.
- Do not store the vehicle in direct sunlight for extended periods of time.
- Exposure to sunlight may deactivate color change feature.
- Only use water on the vehicles, as other liquids may cause irreparable damage.
- Avoid submerging vehicles into water as doing so can damage the vehicles.
- Dry off vehicles with a dry cloth or air dry vehicles. Do not place under direct or excessive heat.
- Keep long hair and other loose objects, like shoelaces, away from the rotating tires of the vehicle.
- Do not play with car in the street or where there is vehicular traffic or in heavily traveled areas with pedestrians.
- Avoid driving the car through water, mud, etc.
- It is recommended to drive the car on hard and flat surface.

LIMITED WARRANTY

The Little Tikes Company makes fun, high quality toys. We warrant to the original purchaser that this product is free of defects in materials or workmanship for one year * from the date of purchase (dated sales receipt is required for proof of purchase). At the sole election of The Little Tikes Company, the only remedies available under this warranty will be the replacement of the defective part or replacement of the product. This warranty is valid only if the product has been assembled and maintained per the instructions. This warranty does not cover abuse, accident, cosmetic issues such as fading or scratches from normal wear, or any other cause not arising from defects in material and workmanship. *The warranty period is three (3) months for daycare or commercial purchasers.

U.S.A. and Canada: For warranty service or replacement part information, please visit our website at www.littletikes.com, call 1-800-321-0183 or write to: Consumer Service, The Little Tikes Company, 2180 Barlow Road, Hudson OH 44236, U.S.A. Some replacement parts may be available for purchase after warranty expires—contact us for details.

Outside U.S.A. and Canada: Contact place of purchase for warranty service. This warranty gives you specific legal rights, and you may also have other rights, which vary from country/state to country/state. Some countries/states do not allow the exclusion or limitation of incidental or consequential damages, so the above limitation or exclusion may not apply to you.

Please keep this manual as it contains important information.



© The Little Tikes Company, an MGA Entertainment company. LITTLE TIKES® is a trademark of Little Tikes in the U.S. and other countries. All logos, names, characters, likenesses, images, slogans, and packaging appearance are the property of Little Tikes.

Printed in China
0422-0-E/INT

Little Tikes Consumer Service
2180 Barlow Road
Hudson, Ohio 44236 U.S.A.
1-800-321-0183

MGA Entertainment UK Ltd.
50 Presley Way, Crownhill, Milton
Keynes, MK8 0ES, Bucks, UK
support@LittleTikesStore.co.uk
Tel: +0 800 521 558

MGA Entertainment (Netherlands) B.V.
Baronie 68-70, 2404 XG Alphen a/d Rijn
The Netherlands
Tel: +31 (0) 172 758038



www.littletikes.com
www.littletikes.co.uk
www.littletikes.com.au

Imported by MGA Entertainment Australia Pty Ltd
Suite 2.02, 32 Delhi Road
Macquarie Park NSW 2113
1300 059 676