

11 Start the Foam Party

Plug the blower and turn it on by moving the switch on the side of the blower from the OFF position to the ON. Then, plug in the pump.

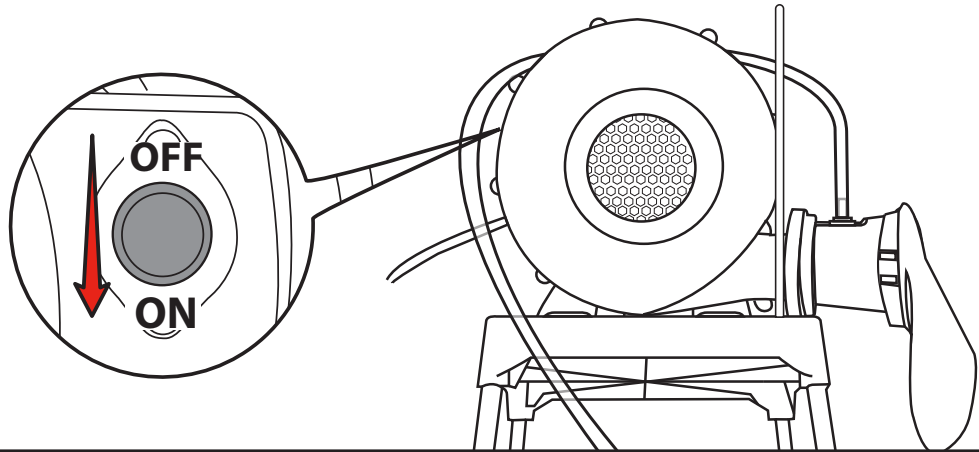

Foam Party Tricks

- Before playing, make sure the electrical plugs are a safe distance away from the water and foam.
- The foam machine can be placed on grass or concrete surfaces, but it is recommended to use on grass.
- This product is soapy and can cause certain surfaces to become slippery. Always use caution when walking on slippery surfaces.
- For more voluminous foam, it is recommended to use the foam machine in a smaller contained area.
- To evenly spread the foam in larger areas, an adult should remove the blower from the stand and move it around the play area.
- An adult must always supervise while the machine is running to avoid the foam bubbles getting sucked into the machine. Keep the machine away from the foam at all times and do not allow the foam to rise above the stand.
- Do not set up machine during windy or rainy weather.

Store until your next party!

Before storing, it is important to drain any remaining foam from the pump. Fill the bin one quarter of the way with water and then allow the machine to run to clear out any soapy foam from the pump. Once the machine has filtered through the water begin disassembling the foam machine as described below.

IMPORTANT NOTE: Allow the contents to air dry thoroughly before storing in the bin.

1. Turn off the blower. Then, unplug the blower and pump.
2. Disconnect the hose from both the blower and pump. Then, remove the blower from the stand.
3. Remove the mesh sock and allow it to air dry.
4. Twist off and remove the adapter.
5. Disassemble the stand.
6. Store the contents in the bin.

Time to tidy up!

- Once the foam has dried out, hose down the area with water. Repeat a couple of times until the surface is no longer slippery.
- Wash off any remaining residue on your body with mild soap and water.

Having problems?

PROBLEM	SOLUTION
Foam got into the blower.	Turn the blower off and allow it to dry out before using again.
Foam isn't growing.	<ul style="list-style-type: none">• Check that the solution is 5:1. It should be five parts of water to one part of foam solution.• Use in a smaller contained area.
Foam is too wet.	Check that the solution is 5:1. It should be five parts of water to one part of foam solution.
Pump does not draw water or the flow is slow.	Make sure it is plugged in and the power supply is compatible.
Pump is making noises.	The water level is lower than the water intake.
Pump is not working.	There might be an internal issue. Contact Consumer Service at 1-800-321-0183.
Ran out of solution.	FOAMO refills are available in select retailers. Visit www.getfoamo.com for more information.



SKU: 658679

ADULT ASSEMBLY REQUIRED
ADULT SUPERVISION REQUIRED

ASSEMBLY INSTRUCTIONS

FOR ASSEMBLY
VIDEO & MORE
INFORMATION VISIT:
WWW.GETFOAMO.COM

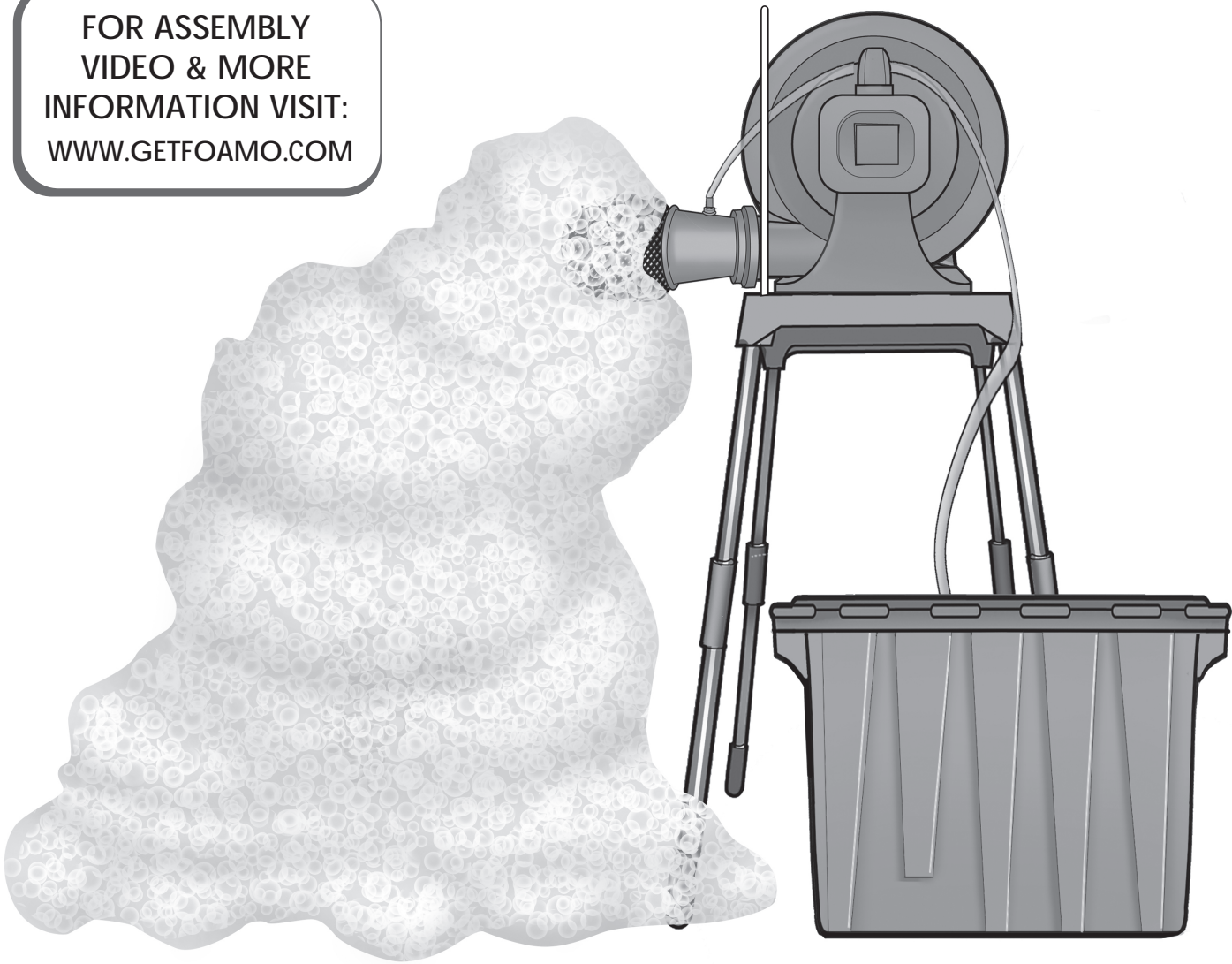

Thank you for purchasing FOAMO™.
We strive to provide a durable, easy-to-assemble toy that is made to last,
giving your family years of imaginative, engaging fun!

READ AND SAVE THESE INSTRUCTIONS

IMPORTANT INFORMATION YOU SHOULD KNOW!

- Read through all the instructions first.
- Clear a flat surface to lay out all the materials so that everything is close at hand.
- Illustrations are for reference only. Styles may vary from actual contents.
- Please remove all packaging including tags, ties & tacking stitches before giving this product to a child.
- Only use FOAMO™ solution with this product, as other solutions may damage the machine.
- For refill information, visit www.getfoamo.com.
- **Make sure you have all contents before assembling. If anything is missing or if you have questions, we're here to help. Give our consumer service team a call at 1-800-321-0183.**

Let's be careful!

! WARNING!

- ADULT ASSEMBLY REQUIRED.
- Please keep this manual as it contains important information.
- This product is intended for outdoor family use only.
- This product is soapy and can cause certain surfaces to become slippery. Always use caution when walking on slippery surfaces.
- Always keep the electrical plugs away from the water and foam to avoid electrocution.
- Keep foam solution out of reach of children.
- Eye irritation may occur. Keep foam and foam solution away from eyes.
- In case of eye contact, rinse with water for 10-15 minutes.
- Do not ingest foam or foam solution.
- Do not allow children to sit, stand, play or climb on the top surface. Failure to do so may cause the product to become unstable.
- To better clean the product, use a damp cloth.
- **WARNING!** Never leave your child unattended even for the shortest time. Children must be under constant supervision at all times.



'Let's care for the environment!'

The wheelie bin symbol indicates that the product must not be disposed of with other household waste. Please use designated collection points or recycling facilities when disposing of the item.

© The Little Tikes Company, an MGA Entertainment company. LITTLE TIKES® and FOAMO™ are trademarks of Little Tikes in the U.S. and other countries. All logos, names, characters, likenesses, images, slogans, and packaging appearance are the property of Little Tikes.
Printed in China • 1121-2-E

CONSUMER SERVICE

Little Tikes Consumer Service
www.littletikes.com
2180 Barlow Road
Hudson, Ohio 44236 U.S.A.
Email: service@littletikescare.com
1-800-321-0183 Monday-Friday



LIMITED WARRANTY

The Little Tikes Company makes fun, high quality toys. We warrant to the original purchaser that this product is free of defects in materials or workmanship for one year * from the date of purchase (dated sales receipt is required for proof of purchase). Warranty on the hose included with this product is 90-days from the date of purchase. At the sole election of The Little Tikes Company, the only remedies available under this warranty will be the replacement of the defective part or replacement of the product. This warranty is valid only if the product has been assembled and maintained per the instructions. This warranty does not cover abuse, accident, cosmetic issues such as fading or scratches from normal wear, or any other cause not arising from defects in material and workmanship. *The warranty period is three (3) months for daycare or commercial purchasers.

U.S.A. and Canada: For warranty service or replacement part information, please visit our website at www.littletikes.com, call 1-800-321-0183 or write to: Consumer Service, The Little Tikes Company, 2180 Barlow Road, Hudson OH 44236, U.S.A. Some replacement parts may be available for purchase after warranty expires—contact us for details.

Outside U.S.A. and Canada: Contact place of purchase for warranty service. This warranty gives you specific legal rights, and you may also have other rights, which vary from country/state to country/state. Some countries/states do not allow the exclusion or limitation of incidental or consequential damages, so the above limitation or exclusion may not apply to you.

9 Connect the Other End of the Hose

Slide the other end of the hose (E) through the handle on the blower and over the slit on the board (J). Then, insert it into the apparatus on the adapter.

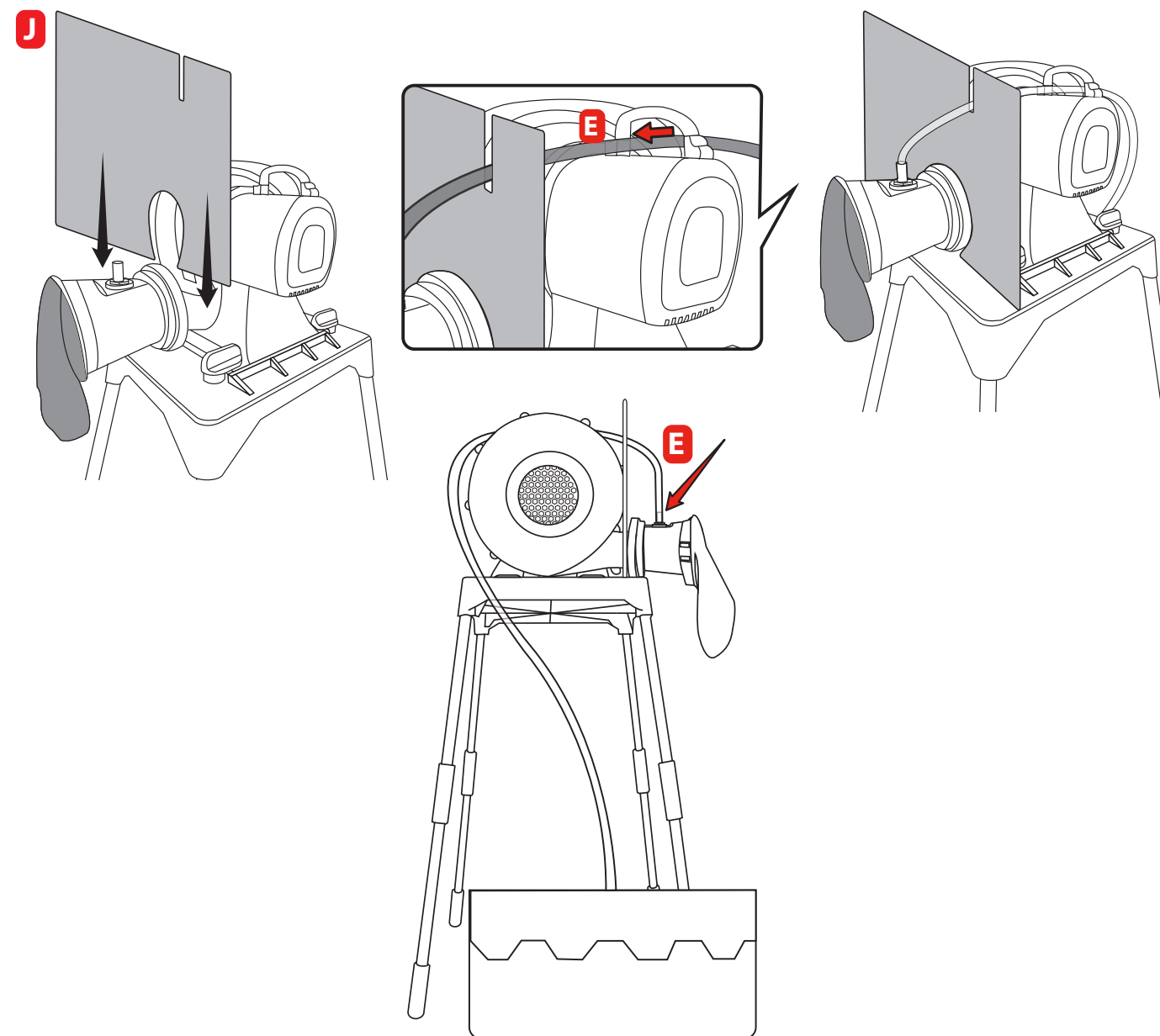

10 Add Water and Foam Solution

Fill the bin with water up the fill line located inside on the shorter side of the bin. Then, add the whole bottle of foam solution. Mix the solution and slightly close the lid. Do not tightly close the lid to avoid damaging the hose and pump's wire. Always wash your hands after contact with the solution.

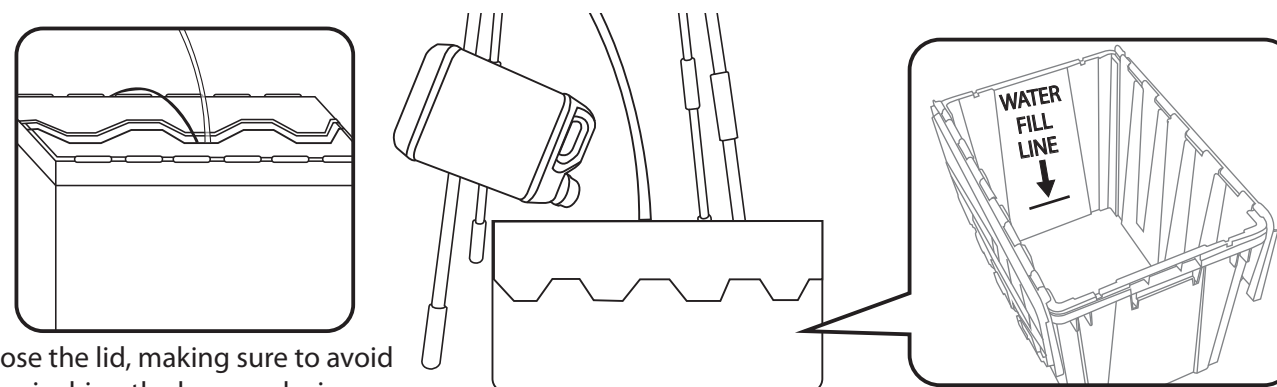

Close the lid, making sure to avoid pinching the hose and wire.

7 Secure the Foam Machine the Stand

Lift up and slide out the locks on the stand. Then, slide the foam machine's legs into slots on the stand. Secure it in place by lifting and sliding the locks over the openings on the back of the foam machine.

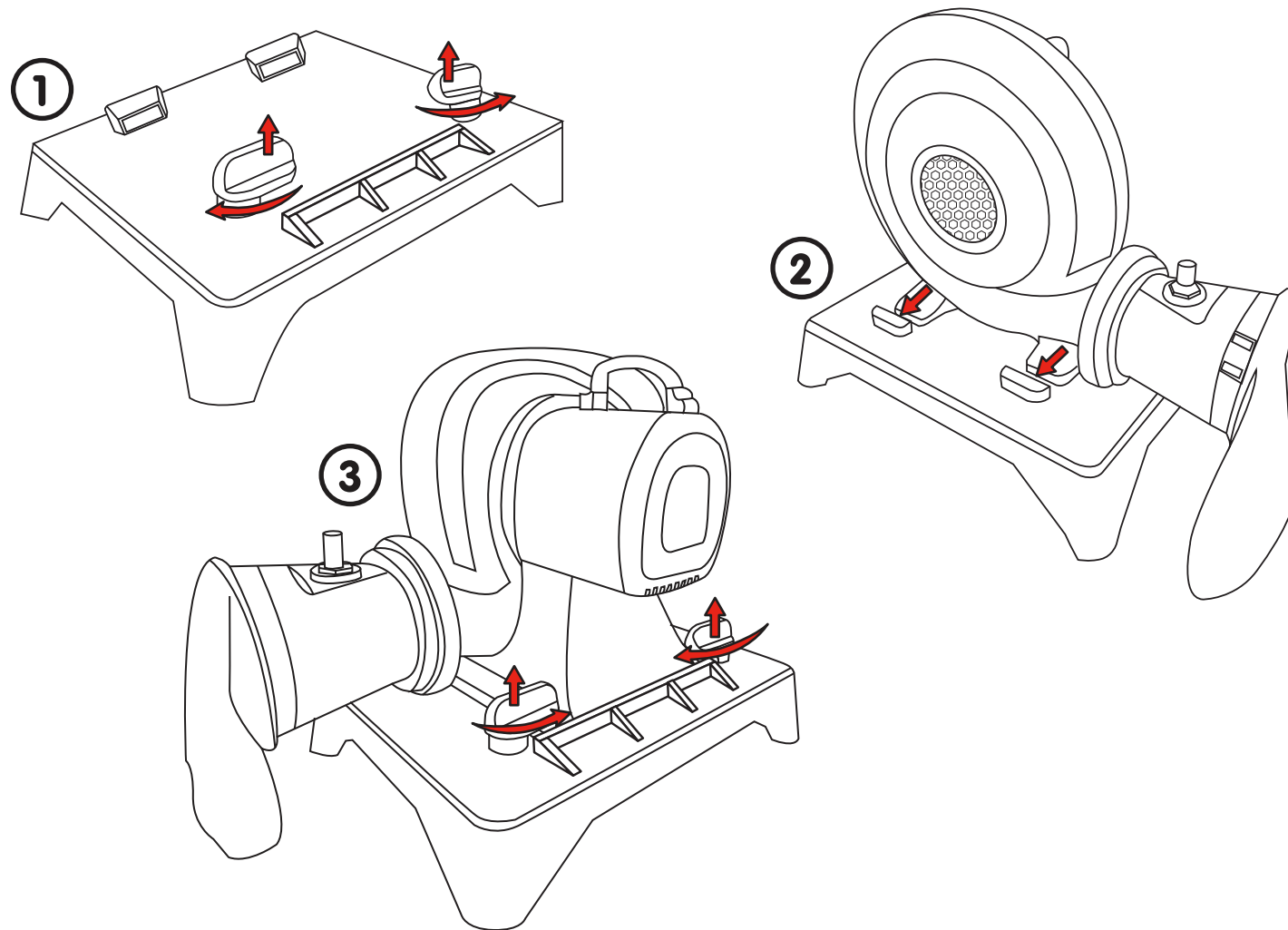

8 Prepare the Pump

Place the pump (D) into the bin and attach the suction cups under the pump to the bottom floor of the bin. Then, insert one side of the hose (E) into the tube of the pump.

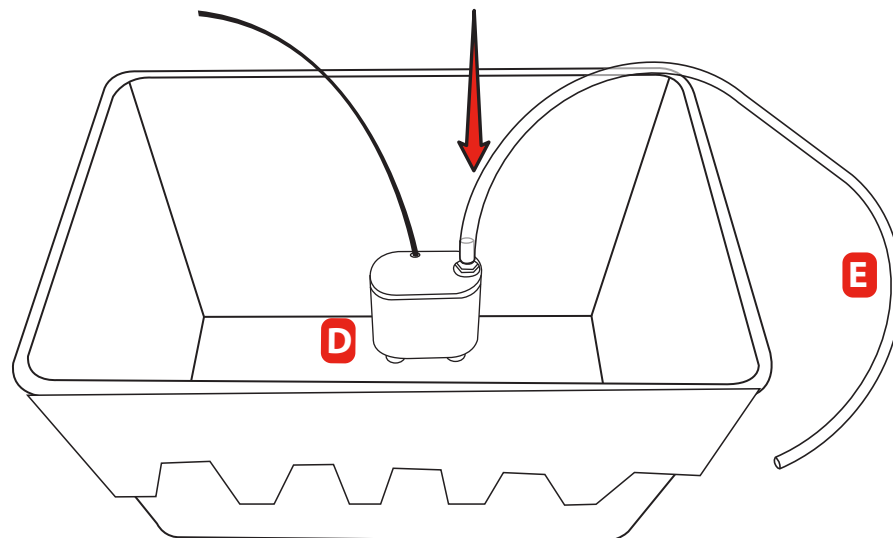

CAUTION - ELECTRICALLY OPERATED PRODUCT.
OPERATION OF BLOWER FAN UNIT NOT RECOMMENDED FOR CHILDREN UNDER 8 YEARS OF AGE. AS WITH ALL ELECTRONIC PRODUCTS, PRECAUTIONS SHOULD BE OBSERVED DURING HANDLING AND USE TO PREVENT ELECTRIC SHOCK.

WARNING: FAILURE TO FOLLOW THESE INSTRUCTIONS COULD RESULT IN SERIOUS INJURY OR DEATH.

Do not use extension cords with this product. Outdoor use.
 Read all instructions before assembling this device. Keep instructions for future use.

WARNING

ELECTROCUTION RISK:

- KEEP ALL ELECTRICAL LINES, RADIOS, SPEAKERS AND OTHER ELECTRICAL DEVICES AWAY FROM THE CONSTANT FOAM MAKER.
- DO NOT PLACE THE CONSTANT FOAM MAKER NEAR OR UNDER OVERHEAD ELECTRICAL LINES.

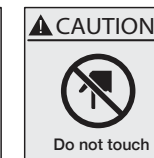
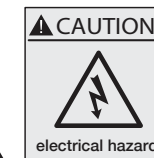

⚠ BLOWER CAUTIONS:

- Do not open or try to service the blower. If blower needs servicing, take it to a reputable dealer.
- Clearly mark the path of the power cord to avoid tripping and/or damage by yard equipment such as lawn mowers, etc.
- Do not leave blower unattended.
- Do not allow blower to be used or played with by children.
- Do not cover the air intakes when the blower is being used and do not insert small objects into any part of the blower.
- **WARNING** - Electrical Hazard - DO NOT USE EXTENSION CORDS WITH THIS PRODUCT.
- Disconnect the blower from the power source when moving the blower.
- **WARNING** - To reduce the risk of fire or electric shock, do not use this blower with any solid - state speed control device.
- The blower should be secure to the stand before use.

BLOWER MAINTENANCE

- Blower must be unplugged before servicing.
- Product should be periodically examined for potentially unsafe conditions such as damaged cord, plug, housing, or parts, and that in the event such damage is found, the product should not be used until properly repaired. If these checks are not carried out, the product could overturn or otherwise become a hazard.
- The blower does not require any lubrication and has no user serviceable parts. Do not attempt to service the blower.
- Do not immerse the blower in water. To clean, wipe with a damp cloth.
- Regularly inspect the intake and output openings and keep free of dirt, leaves, etc.
- When not in use, store the blower indoors in a dry place.
- Store the blower upright on a stable surface.
- Loosely coil the cord and place it beside the blower.
- When in use, do not place the cord across traffic areas, water or damp areas.
- The blower is a high volume blower, capable of moving large volumes of air very quickly. Place the blower in an area where it will not draw in dirt or leaves.
- Do not operate any fan with a damaged cord or plug. Discard fan or return to an authorized service facility for examination and/or repair.
- Do not run cord under carpeting. Do not cover cord with throw rugs, runners, or similar coverings. Do not route cord under furniture or appliances. Arrange cord away from traffic area where it will not be tripped over.

Disposal

- Disassemble and dispose of the equipment in such a manner that no hazardous conditions exist at the time the equipment is discarded.
- Blower should be returned to a collection center capable of processing electrical/electronic waste.

⚠ Safety Warnings: ELECTRICAL BLOWER



MODEL SW-1L

BLOWER SPECIFICATIONS: 115V (AC), 60 Hz, 2.8A, 322W

DANGER

⚠ CAUTION: ELECTRICALLY OPERATED PRODUCT

⚠ DANGER - TO PREVENT ELECTRIC SHOCK, DO NOT IMMERSE IN WATER. WIPE CLEAN WITH DAMP CLOTH.

⚠ WARNING: FAILURE TO FOLLOW THESE INSTRUCTIONS COULD RESULT IN SERIOUS INJURY OR DEATH. ADULT SET-UP AND SUPERVISION REQUIRED.

⚠ CAUTION: The blower is a high volume blower, and is capable of moving lots of air very quickly. Place the blower in an area where it will not suck in dirt or leaves. Keep away from water and traffic. Keep children away from the blower. Only the blower supplied should be used for creating foam.

INSTRUCTIONS FOR BLOWER INSTALLATION

NOTE: Set up as close to power source as possible. The product should be periodically examined for potentially unsafe conditions such as: damaged cord, plug, housing or parts, and that in the event such damage is found, the product should not be used until properly repaired. Never leave the blower outside in the rain or exposed to the elements when not in use. When in use, do not place the cord across traffic areas, water or damp areas. The blower should be placed on a stable surface and anchored per product instructions. The power cord of the blower is equipped with a Ground Fault Circuit Interrupter (GFCI) plug.

- 1) Make sure that the blower switch is in the "OFF" position. Plug the blower into a properly grounded 110-120V GFCI outlet.
- 2) If the GFCI has been tripped, press the "RESET" button to restore power to the blower.
- 3) Set the power switch of the blower to "ON." After use, turn the power to "OFF."
- 4) To disconnect, have an adult grip it tightly and pull the plug from wall outlet.

⚠ WARNING: Failure to follow these instructions could result in serious injury or death.

- Cautionary statements should be read before beginning assembly.
- ADULT SET-UP AND SUPERVISION REQUIRED.
- Use only with Ground Fault Circuit Interrupt (GFCI) receptacle.
- This blower is for residential use only. It is not intended to be used in commercial or industrial settings.
- Never insert fingers, pencils or any other object through the grill at ANY time.
- Do not operate blower with a damaged cord or plug, after the appliance malfunctions or has been dropped or damaged in any manner.
- Do not operate in the presence of explosive and/or flammable fumes.
- Never connect the blower to any solid - state speed control device.
- To reduce the risk of fire or electric shock, do not use this blower with any solid-state speed control device.
- WARNING - Electronic hazard - Do not use extension cords with this product. If power supply cord is too short, have a qualified electrician install an outlet near the appliance.
- Always unplug the blower before servicing.
- For outdoor use.
- Only install foam machine over grass or concrete surfaces.
- Do not install or use the foam machine during rainy, windy or excessively hot weather.

⚠ WARNING

Electrocution Hazard- DO NOT USE EXTENSION CORDS WITH THIS PRODUCT.

INSTRUCTIONS FOR BLOWER CLEANING AND STORAGE

Do not immerse the blower in water. Unplug the blower before cleaning. To clean: wipe with a damp cloth. The blower does not require any lubrication and has no user serviceable parts. Do not attempt to service the blower. When not in use, store the blower indoors in a dry place. Store the blower upright on a stable surface. Loosely coil the cord and place it beside the blower.

GROUNDING METHODS

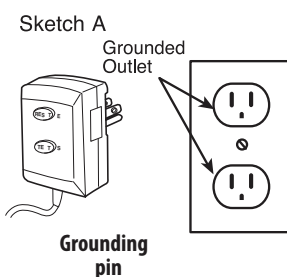

USE ONLY ON GFCI PROTECTED RECEPTACLES ⚠ CAUTION ⚠ GROUNDING INSTRUCTIONS FOR ALL GROUNDED, CORD-CONNECTED PRODUCTS

This product should be grounded. In the event of an electrical short circuit, grounding reduces the risk of electric shock by providing an escape wire for the electrical circuit. This product is equipped with a cord having a grounding wire with an appropriate grounding plug. DANGER - Improper installation of the grounding plug can result in a risk of electric shock. If repair or replacement of the cord or plug is necessary, do not connect the grounding wire to either flat blade terminal. The wire with insulation having an outer surface that is green, with or without yellow stripes, is the grounding wire. Check with a qualified electrician or serviceman if the grounding instructions are not completely understood, or if in doubt as to whether the product is properly grounded. Do not modify the plug provided; if it will not fit the outlet, have the proper outlet installed by a qualified electrician. This product is for use on a nominal 110-120 volt supply circuit, and has a grounding plug that looks like the plug illustrated in sketch A. Temporary adapters should not be used. Do not use product until a properly grounded outlet (sketch A) can be installed by a qualified electrician.

This blower is not a toy. Use under the direct supervision of a competent adult. Keep away from children.
THIS INSTRUCTION BOOKLET CONTAINS IMPORTANT SAFETY INFORMATION. PLEASE READ AND KEEP FOR FUTURE REFERENCE.

5 Assemble the Foam Machine

Attach the adapter (B) to the blower (A). Twist to lock in place, making sure that the foam apparatus is seated on the top of the adapter.

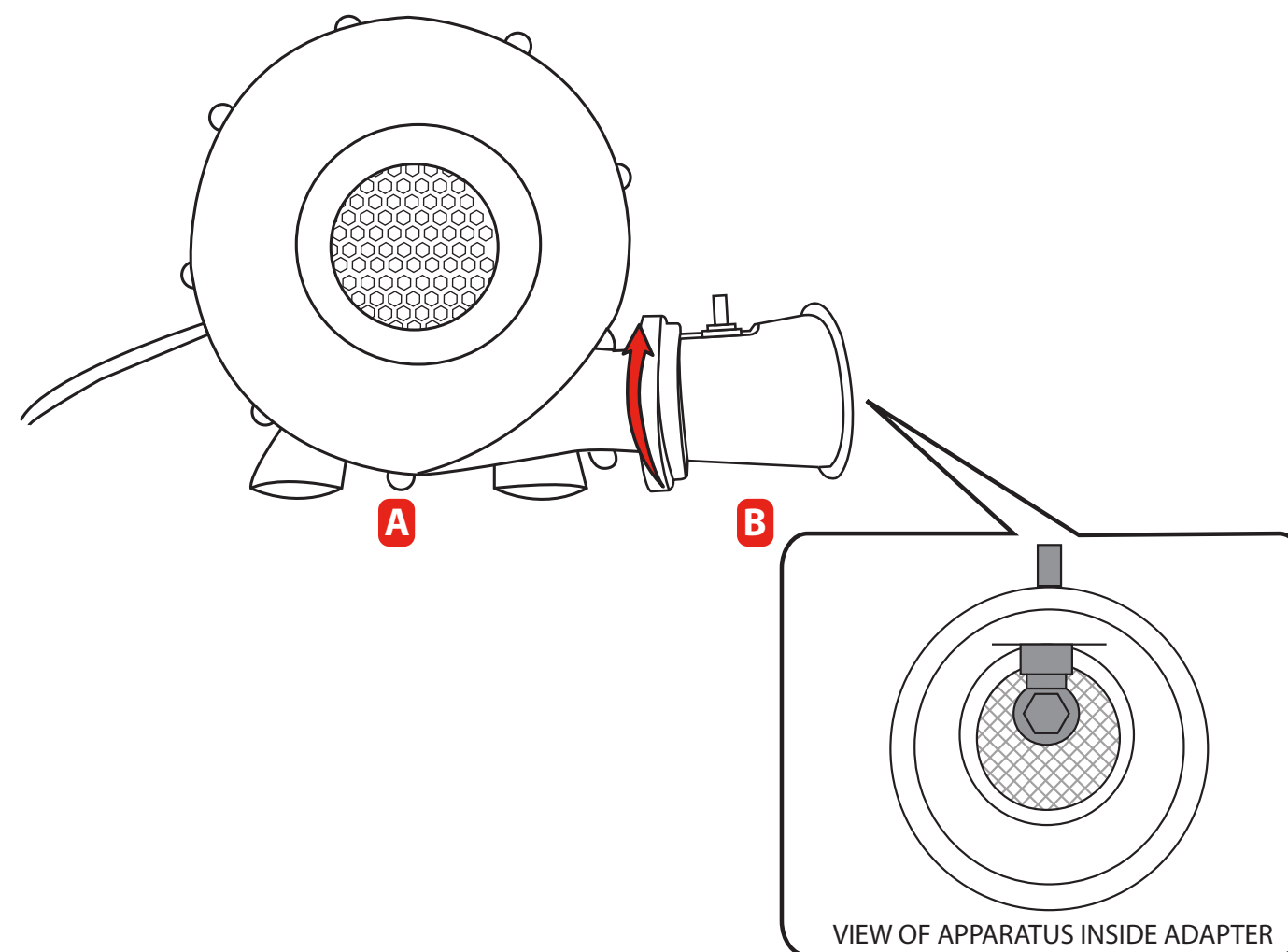

6 Time to Add the Mesh Sock

Wrap the mesh sock (C) around the adapter (B). Secure it by closing the hook and loop fastener on the mesh sock.

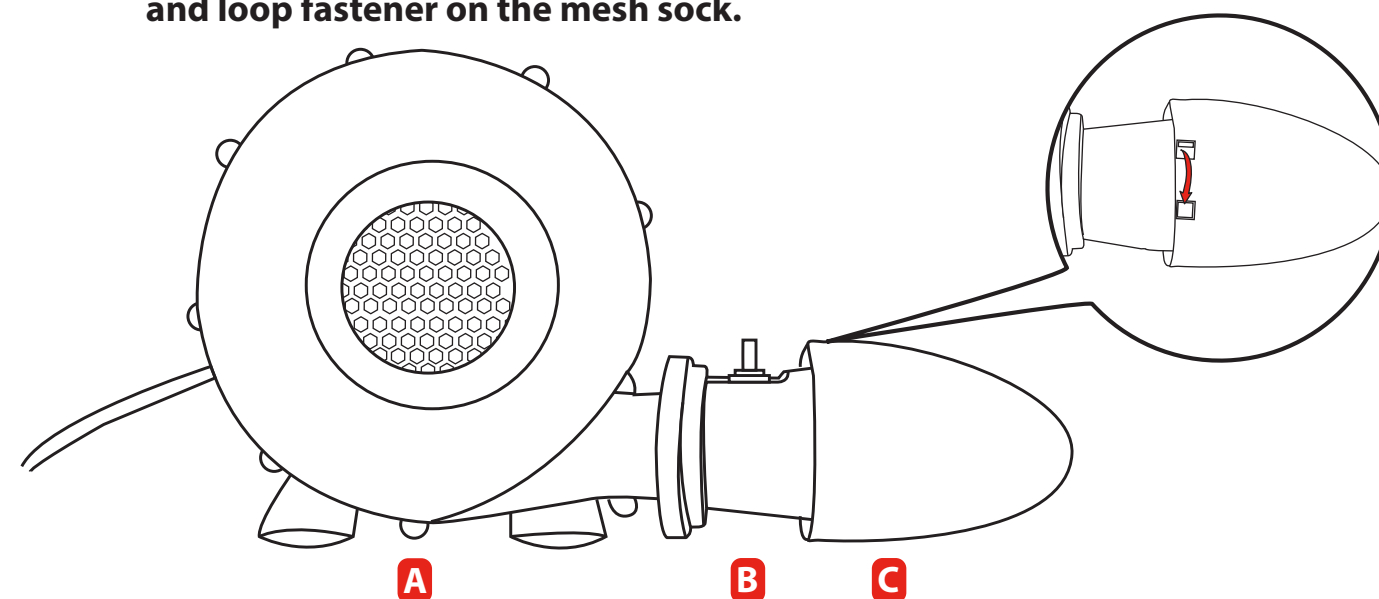

3 Finish the Legs

Insert the last four legs (F) into the connectors (H).

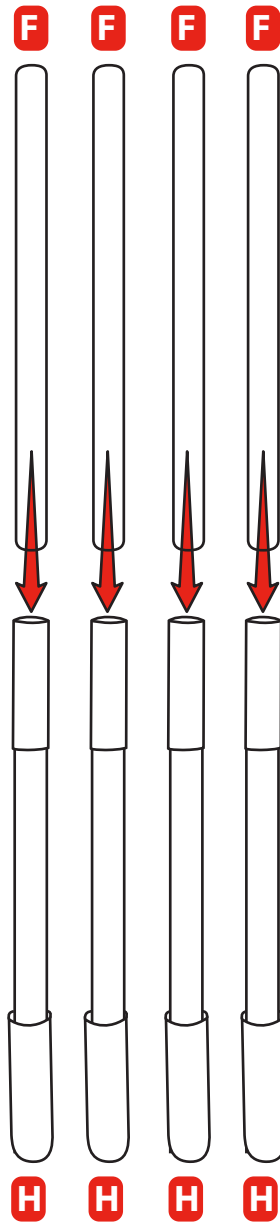

4 Top it Off

Attach the legs to the bottom of the table (I).

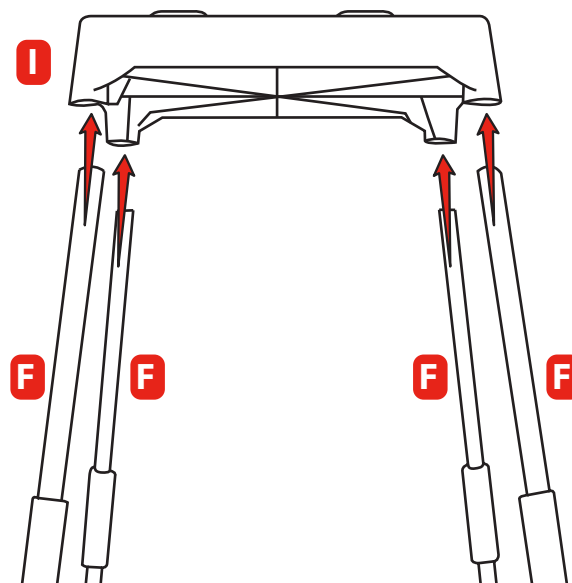

Safety Warnings: BLOWER SET UP

Foam play is not intended for indoor use.

ADULT SUPERVISION AND SET UP REQUIRED. This product should be assembled or disassembled only by a competent adult. Follow all instructions provided.

WARNING! Product can cause slippery surfaces. Falls onto hard surfaces can result in head or other serious injuries. Only use the foam machine on grass or concrete and supervise younger children.

- WARNING! Only for domestic use. Intended for outdoor domestic family use only. Not for use in public areas or as a rental.
- Product is heavy. Use caution when lifting.
- Product should never be dragged across concrete, pavement or other rough surfaces.
- Do not set up in rainy, windy or excessively hot conditions.
- Set-up in outdoor location only that meets the following criteria:
 - Place on level ground and firm grass or soil.
 - Placing on slanted or uneven surfaces may cause the product to tip.
 - Minimum clearance zones: Place at least 6.6 ft. (2m) away from any other objects.
 - Objects to be avoided include but are not limited to fences, buildings, trees, overhead branches, laundry lines, electrical wires, walls, or bodies or sources of water.

NOTE: Position the blower motor perpendicular and leveled. Make sure that the blower is upright on a stable surface. Do not place the blower in an area where it can draw up dirt, leaves and other debris. Make sure that the blower is at least 6.6 ft. (2m) away from any structure or obstacle such as a fence, garage, overhanging branches or electrical wires.



Safety Warnings: ELECTRICAL PUMP

- Before using, make sure the power supply is compatible with the pump. This pump is operated by 120V AC, 60Hz, 23W power supply.
- Pump should be periodically examined for potentially unsafe conditions such as damaged cord, plug, housing, or parts, and that in the event such damage is found, the product should not be used until properly repaired. If the plug on the power cable is damaged or cracked, discontinue use immediately.
- If pump is making abnormal noises or has an odor, unplug it from the power supply and do not use until it is properly repaired.
- Only use in water with temperature of 32° F (0° C) to 95° F (35° C), as temperature below or above this range will damage the pump.
- Pump should only be operated in depths of 3.2 ft. (1 m).
- Always handle the product with care. In case of a serious impact, inspect the product and discontinue use if there are signs of damage.
- Disconnect from the power supply when cleaning or installing the pump to prevent electric shock.
- Before connecting or disconnecting, always make sure the power plug and your hands are dry to avoid electric shock.
- Never operate out of the water or allow it run idle for more than five minutes, as this can cause damage to the pump.
- To clean: wipe with a damp cloth.



Safety Warnings: FAILURE TO FOLLOW THESE INSTRUCTIONS COULD RESULT IN SERIOUS INJURY OR DEATH.



Adult supervision required. Do not leave children unattended.



Do not use in windy conditions.



Do not leave out in rain.



Do not allow children to touch fan or electrical cord.

- **Constant, competent adult supervision of children and other young users is required at all times.**
- Keep the area around the product clean, and clear of objects, to prevent slips and falls.
- This product is soapy and can cause certain surfaces to become slippery. Always use caution when walking on slippery surfaces.
- Instruct children on proper use of this product. Do not use in a manner other than intended.
- Helmets, headgear, shoes, glasses, loose clothing, scarves, hoods, or clothing containing drawstrings should not be worn when using this product.
- Instruct children not to attach items to the product that are not specifically designed for use with the equipment.
- Keep pets away from product.
- Do not jump onto or off of product.
- Thoroughly dry before use.
- Always dry product before storage.
- Always check product and all its anchorage points during use, and re-secure, as appropriate.
- As an outdoor product, this foam machine is subject to wear and deterioration. Keep product properly maintained and watch for signs of wearing.
- Always drain product after use. Do not leave product full of water overnight.
- Instruct all children never to drink foam solution.
- Before and during use, check that the blower is properly connected.
- After turning on, the blower should run continuously while children are playing.
- The product should be periodically examined for potentially unsafe conditions such as: damaged cord, plug, housing, or parts, and that in the event such damage is found, the product should not be used until properly repaired. Never leave the fan outside in the rain or elements when not in use. Refer to the instructions for set-up, storage, maintenance and care.

A Few Things Before You Start!

BEFORE you begin assembly, make sure you have all the parts listed below.
Questions? We're here to help. Little Tikes® Consumer Service: 1-800-321-0183

Foam Machine Parts

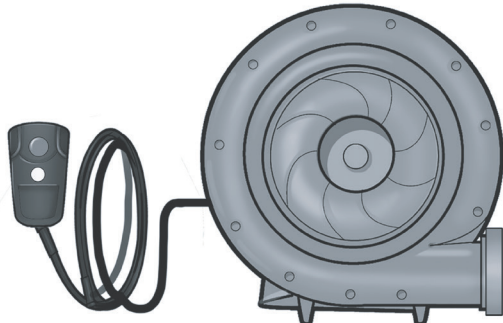

A Blower

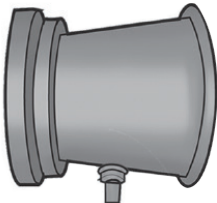

B Adapter



C Mesh Sock

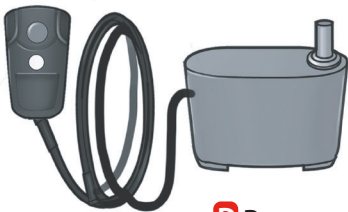

D Pump

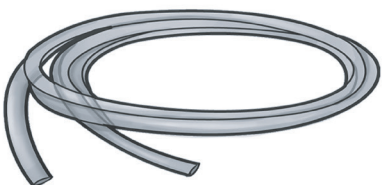

E Hose

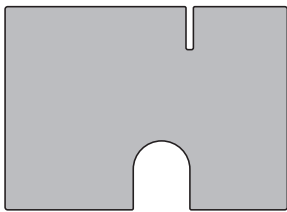

J Board

Stand Parts

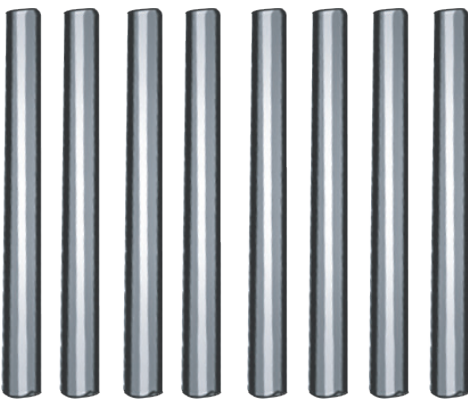

F Legs (8)



G Feet (4)



H Connectors (4)



I Table

Foam Accessories



Foam Solution (1)

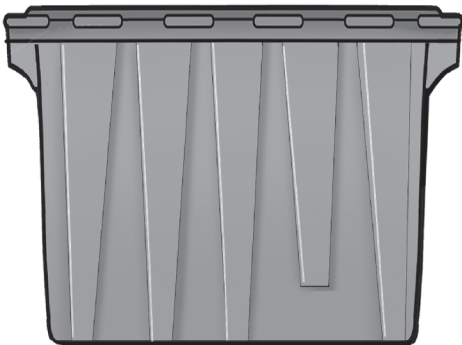

Bin

1

Start with the Legs

Attach the feet (G) to four legs (F).

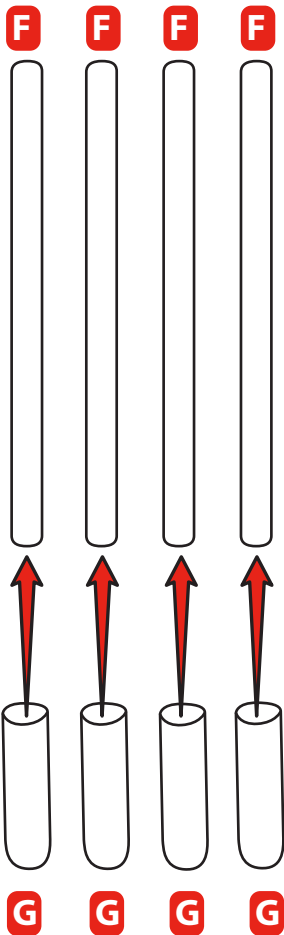

2

Add the Connectors

Insert the connectors (H) to the top of the legs (F).

