

LIMITED WARRANTY

The Little Tikes Company makes fun, high quality toys. We warrant to the original purchaser that this product is free of defects in materials or workmanship for one year * from the date of purchase (dated sales receipt is required for proof of purchase). At the sole election of The Little Tikes Company, the only remedies available under this warranty will be the replacement of the defective part or replacement of the product. This warranty is valid only if the product has been assembled and maintained per the instructions. This warranty does not cover abuse, accident, cosmetic issues such as fading or scratches from normal wear, or any other cause not arising from defects in material and workmanship. *The warranty period is three (3) months for daycare or commercial purchasers. U.S.A and Canada: For warranty service or replacement part information, please visit our website at www.littletikes.com, call 1-800-321-0183 or write to: Consumer Service, The Little Tikes Company, 2180 Barlow Road, Hudson OH 44236, U.S.A. Some replacement parts may be available for purchase after warranty expires—contact us for details. Outside U.S.A and Canada: Contact place of purchase for warranty service. This warranty gives you specific legal rights, and you may also have other rights, which vary from country/state to country/state. Some countries/states do not allow the exclusion or limitation of incidental or consequential damages, so the above limitation or exclusion may not apply to you.

BATTERY SAFETY INFORMATION

- Use only size "AAA" (LR03) alkaline batteries (3 required).
- Charging of rechargeable batteries should only be done under adult supervision.
- Remove rechargeable batteries from the product before recharging.
- Do not mix old and new batteries.
- Do not mix alkaline, standard (carbon-zinc), or rechargeable batteries.
- Be sure to insert the batteries correctly and follow the toy and battery manufacturer's instruction.
- Always remove exhausted or dead batteries from the product.
- Dispose of dead batteries properly: do not burn or bury them.
- Do not attempt to recharge non-rechargeable batteries.
- Avoid short-circuiting battery terminals.
- Remove batteries before placing the unit into storage for a prolonged period of time.

FCC COMPLIANCE

NOTE: This equipment has been tested and found to comply with the limits for a Class B digital device, pursuant to Part 15 of the FCC Rules. These limits are designed to provide reasonable protection against harmful interference in a residential installation. This equipment generates, uses and can radiate radio frequency energy and, if not installed and used in accordance with the instructions, may cause harmful interference to radio communications. However, there is no guarantee that interference will not occur in a particular installation. If this equipment does cause harmful interference to radio or television reception, which can be determined by turning the equipment off and on, the user is encouraged to try to correct the interference by one or more of the following measures:

- Reorient or relocate the receiving antenna.
- Increase the separation between the equipment and receiver.
- Connect the equipment into an outlet on a circuit different from that to which the receiver is connected.
- Consult the dealer or an experienced radio/TV technician for help.

This device complies with Part 15 of the FCC Rules. Operation is subject to the following two conditions: (1) This device may not cause harmful interference, and (2) this device must accept any interference received, including interference that may cause undesired operation.

Caution: Modifications not authorized by the manufacturer may void users authority to operate this device.

CAN ICES-3 (B)/NMB-3(B).



'Let's care for the environment!'

The wheelee bin symbol indicates that the product must not be disposed of with other household waste. Please use designated collection points or recycling facilities when disposing of the item. Do not treat old batteries as household waste. Take them to a designated recycling facility.

Please keep this manual as it contains important information.



© The Little Tikes Company, an MGA Entertainment company. LITTLE TIKES® is a trademark of Little Tikes in the U.S. and other countries. All logos, names, characters, likenesses, images, slogans, and packaging appearance are the property of Little Tikes.

MGA Entertainment UK Ltd
50 Presley Way
Crownhill
Milton Keynes
MK8 0ES
Bucks, UK
0800 521 558



Visit our website at www.littletikes.com to register your product and to enter our sweepstakes. (No purchase necessary)

www.littletikes.com
www.littletikes.co.uk

Little Tikes Consumer Service
2180 Barlow Road Hudson, Ohio 44236
U.S.A.
1-800-321-0183
Printed in China

0418-0-E/INT

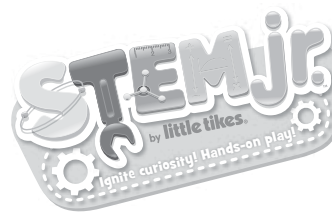

BUILDER BOT™

AGES 3+ YEARS
ADULT SUPERVISION REQUIRED
ADULT BATTERY INSTALLATION REQUIRED

SKU: 647550

CONTENTS

- | | | |
|--------------------|---------------------|-----------------------|
| A. 1 Torso | D. 1 Walking Feet | G. 2 Spinning Arms |
| B. 1 Light-Up Body | E. 1 Rolling Wheels | H. 1 Shovel |
| C. 2 Heads | F. 2 Pinching Hands | I. 1 Propeller |
| | | J. 2 Experiment Cards |

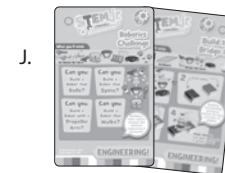
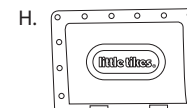
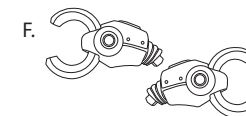
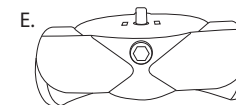
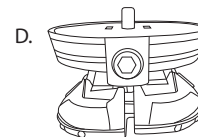
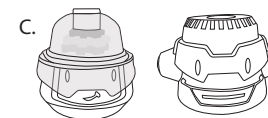
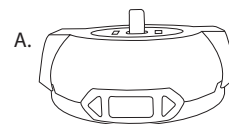

Illustrations are for reference only. Styles may vary from actual contents.

BATTERY INSTALLATION

Before playing, an adult must install fresh alkaline batteries. Here's how:

1. Using a Phillips screwdriver (not included), remove the screw and battery compartment cover located on the back of the robot's light-up body.
2. Install three (3) fresh 1.5V AAA (LR03) alkaline batteries (not included) making sure the (+) and (-) ends face the proper direction as indicated inside the battery compartment.
3. Replace the compartment cover and tighten the screw.

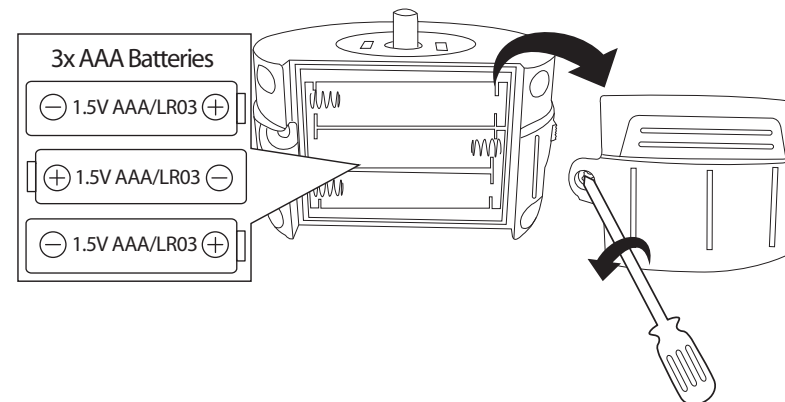

GETTING STARTED

1. Choose an experiment card and begin to discover!
2. Build your robot.
3. Once your robot is ready, move the switch from the OFF (O) position to the ON (I) position.
4. Press the button on the light-up body to make your robot move! Press again to turn it off.

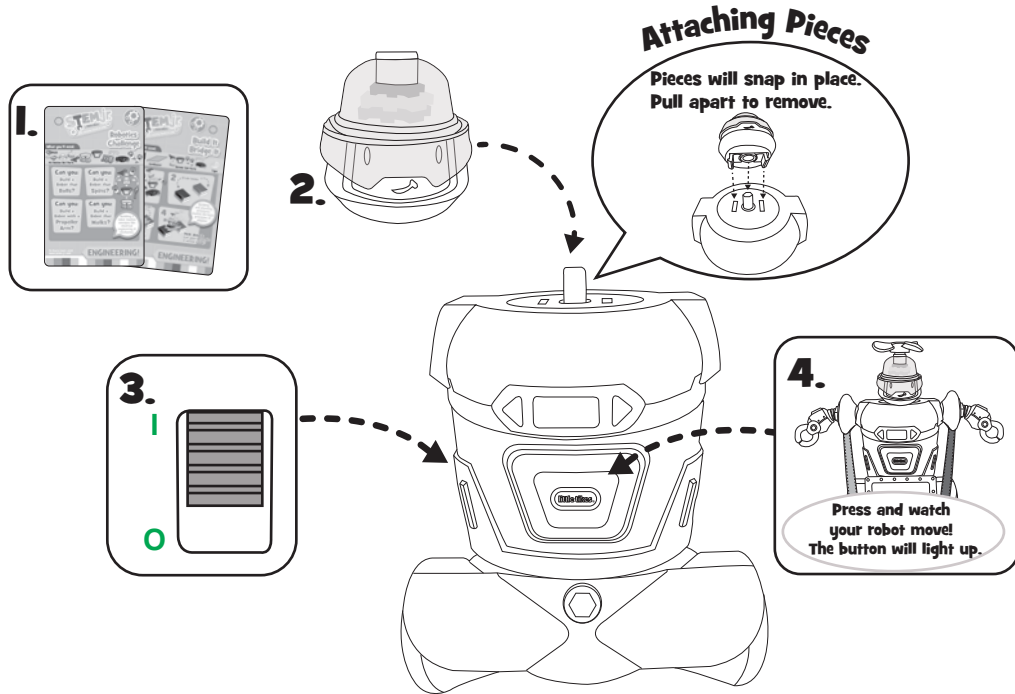

What are your observations? Note your discoveries for each experiment.	
EXPERIMENT #1	EXPERIMENT #2

EXPERIMENT #3	EXPERIMENT #4

Which experiment is right for your child?

Each experiment is designed to address an element of STEM (Science, Technology, Engineering and Math), while encouraging your child to explore their curiosity and develop their critical thinking skills. The best way to do that is through experimentation. While the first time your child tries an experiment may not be perfect, encourage them to try again and watch as they build a foundation for STEM learning.



To learn more visit www.stem-jr.com

IMPORTANT INFORMATION

- Keep these instructions for future reference.
- Adult supervision is required. Do not leave children unattended.
- Do not play with the robot in the street, where there is vehicular traffic or in heavily traveled areas with pedestrians.
- Do not drive robot through water, mud, etc.
- Do not stand on, throw or run the robot and its pieces into furniture, walls, pets, people etc., as doing so may cause injury to the person and irreparable damage to the units.
- Do not allow long hair or loose apparel, such as shoestrings, near the turning parts of the robot.
- There are multiple ways to build your robot.
- Before starting on another experiment, switch from the ON (I) position to the OFF (O) position to avoid turning on the robot when removing the pieces.
- It might take some force to detach the pieces when starting on another experiment.
- If robot stops working or doesn't work as it should, remove the batteries for a few minutes and then re-insert them. If there is still a problem, install new batteries.
- Clean robot with a damp cloth and air dry thoroughly. Keep water away from the battery compartment.
- Switch from the ON position to the OFF position after playing to conserve battery power.